

Soils Map

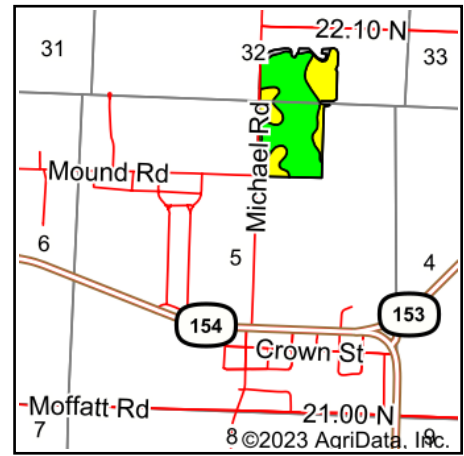

State: **Illinois**
 County: **Randolph**
 Location: **5-5S-5W**
 Township: **Sparta**
 Acres: **55.02**
 Date: **3/27/2023**

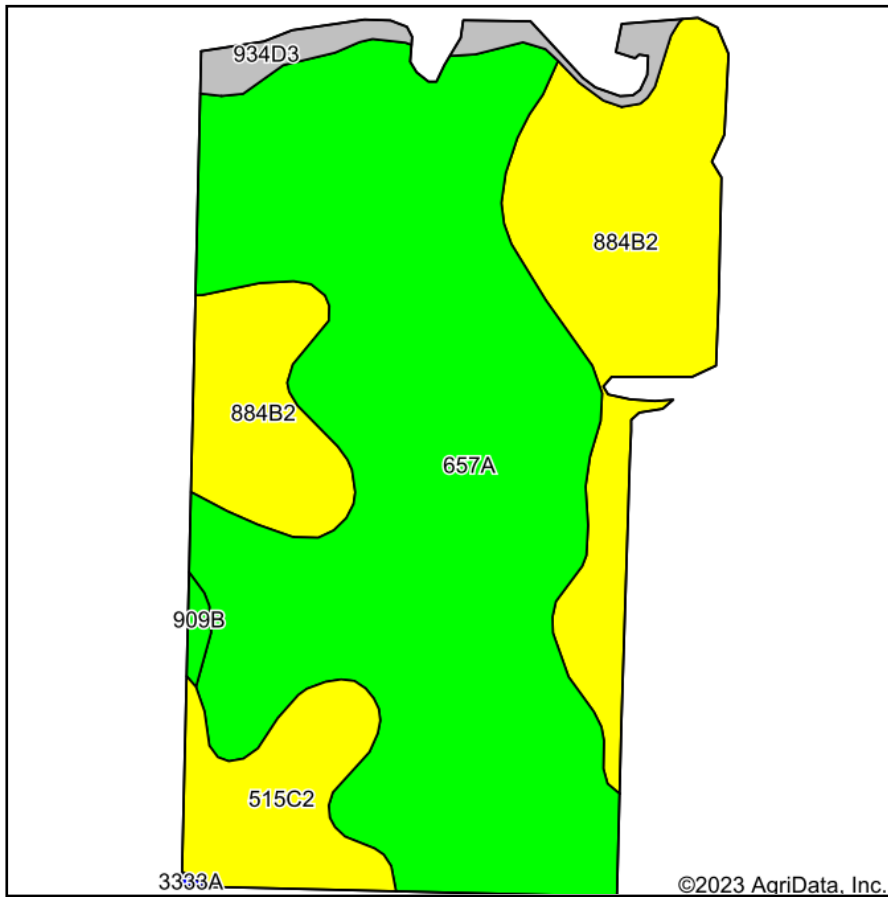

Maps Provided By:
surety
 CUSTOMIZED ONLINE MAPPING
 © AgriData, Inc. 2023 www.AgriDataInc.com



Area Symbol: IL157, Soil Area Version: 16									
Code	Soil Description	Acres	Percent of field	Il. State Productivity Index Legend	Corn Bu/A	Soybeans Bu/A	Wheat Bu/A	Alfalfa hay, T/A	Crop productivity index for optimum management
657A	Burksville silt loam, 0 to 2 percent slopes	34.37	62.5%		144	47	55	0.00	108
**884B2	Bunkum-Coulterville silt loams, 2 to 5 percent slopes, eroded	14.43	26.2%		**139	**46	**52	0.00	**103
**515C2	Bunkum silt loam, 5 to 10 percent slopes, eroded	4.28	7.8%		**136	**47	**52	**3.62	**102
**934D3	Blair-Grantfork silt loams, 10 to 18 percent slopes, severely eroded	1.69	3.1%		**88	**30	**35	0.00	**68
**909B	Coulterville-Oconee silt loams, 2 to 5 percent slopes	0.25	0.5%		**156	**49	**58	0.00	**113
Weighted Average					140.4	46.2	53.4	0.28	105

Table: Optimum Crop Productivity Ratings for Illinois Soil by K.R. Olson and J.M. Lang, Office of Research, ACES, University of Illinois at Champaign-Urbana. Version: 1/2/2012 Amended Table S2 B811

Crop yields and productivity indices for optimum management (B811) are maintained at the following NRES web site: <http://soilproductivity.nres.illinois.edu/>

** Indexes adjusted for slope and erosion according to Bulletin 811 Table S3

d Soils in the poorly drained group were not rated for alfalfa and are shown with a zero "0".

Soils data provided by USDA and NRCS. Soils data provided by University of Illinois at Champaign-Urbana.