

# Soils Map

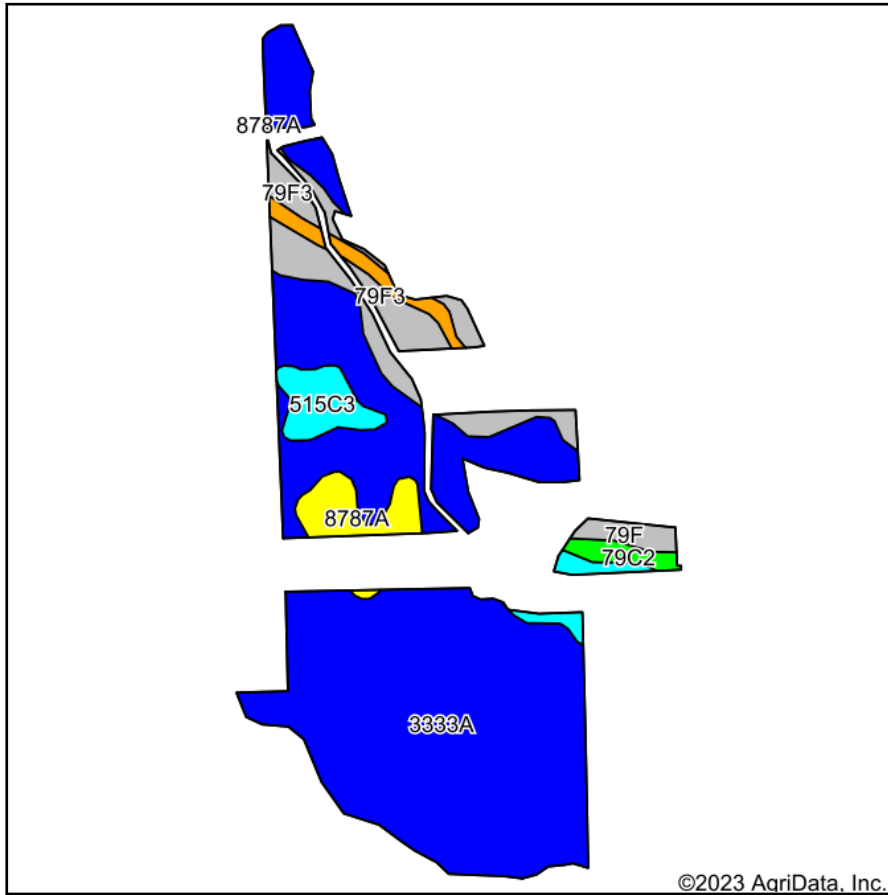

Soils data provided by USDA and NRCS.

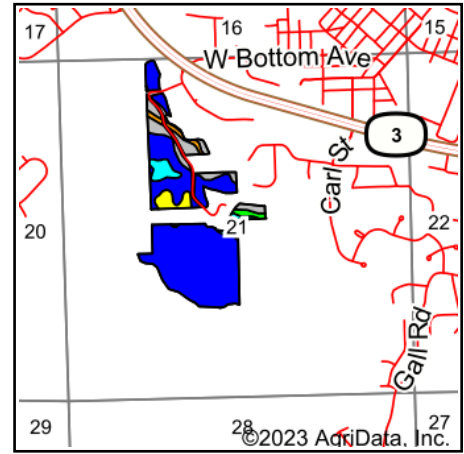

State: **Illinois**  
 County: **Monroe**  
 Location: **21-1S-10W**  
 Township: **Precinct 10**  
 Acres: **65.85**  
 Date: **6/20/2023**



Maps Provided By:  
  
 CUSTOMIZED ONLINE MAPPING  
 © AgriData, Inc. 2023 www.AgriDataInc.com



Area Symbol: IL133, Soil Area Version: 15

Code	Soil Description	Acres	Percent of field	Il. State Productivity Index Legend	Corn Bu/A	Soybeans Bu/A	Wheat Bu/A	Alfalfa d hay, T/A	Crop productivity index for optimum management
3333A	Wakeland silt loam, 0 to 2 percent slopes, frequently flooded	50.02	76.0%		174	56	68	0.00	128
**79F3	Menfro silty clay loam, 18 to 35 percent slopes, severely eroded	6.51	9.9%		**97	**30	**37	**2.89	**71
8787A	Banlic silt loam, 0 to 2 percent slopes, occasionally flooded	2.53	3.8%		142	47	56	0.00	106
**515C3	Bunkum silty clay loam, 5 to 10 percent slopes, severely eroded	2.39	3.6%		**126	**43	**48	**3.35	**95
**79B	Menfro silt loam, 2 to 5 percent slopes	1.43	2.2%		**163	**50	**62	**4.84	**119
**79F	Menfro silt loam, 18 to 35 percent slopes	1.02	1.5%		**117	**36	**45	**3.47	**85
**79D3	Menfro silty clay loam, 10 to 18 percent slopes, severely eroded	0.99	1.5%		**134	**41	**51	**3.96	**97
**79C2	Menfro silt loam, 5 to 10 percent slopes, eroded	0.96	1.5%		**153	**47	**59	**4.55	**112
Weighted Average					161.4	51.8	62.9	0.69	118.8

**Table: Optimum Crop Productivity Ratings for Illinois Soil by K.R. Olson and J.M. Lang, Office of Research, ACES, University of Illinois at Champaign-Urbana.** Version: 1/2/2012 Amended Table S2 B811

Crop yields and productivity indices for optimum management (B811) are maintained at the following NRES web site: <http://soilproductivity.nres.illinois.edu/>

\*\* Indexes adjusted for slope and erosion according to Bulletin 811 Table S3

d Soils in the poorly drained group were not rated for alfalfa and are shown with a zero "0".

Soils data provided by USDA and NRCS. Soils data provided by University of Illinois at Champaign-Urbana.