

**Sale Name:** Absolute Land Auction: 94 ± Acres in St. Clair County

**LOT 1 - Tract 1 - 20.10 ± acres**

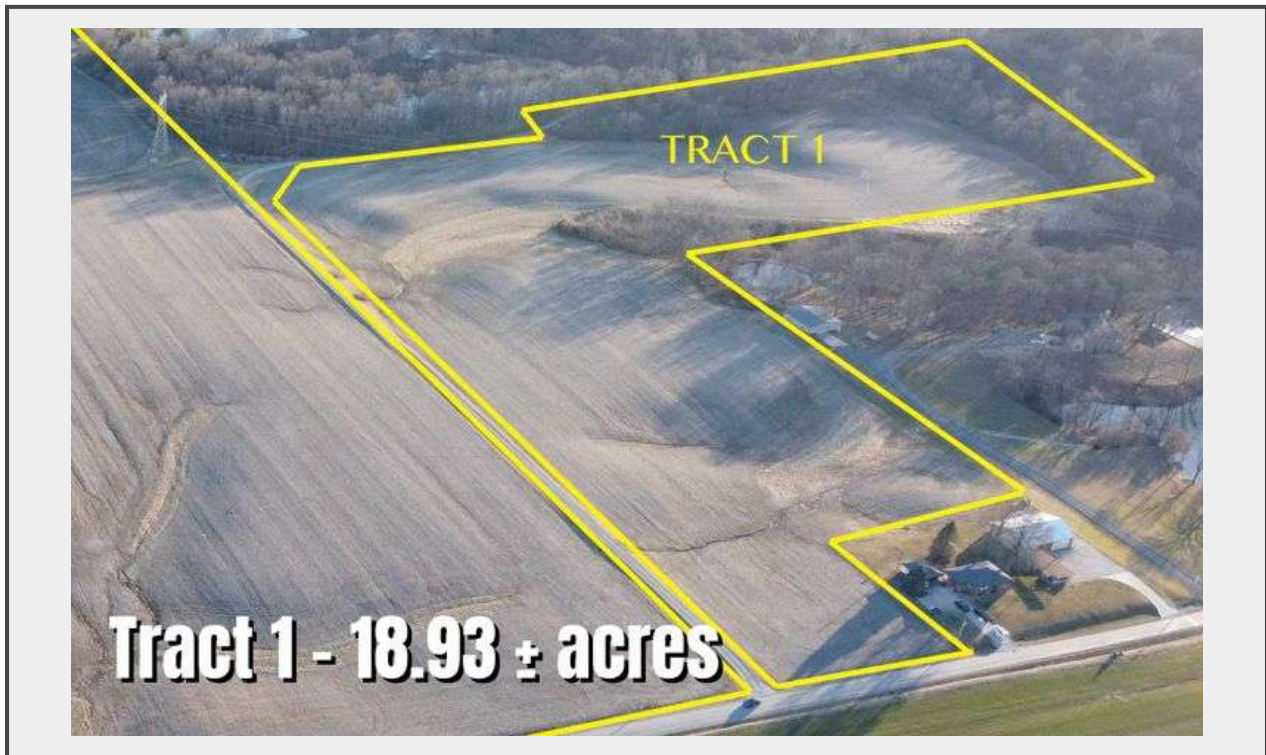

### Description

#### **TRACT 1 Updated to 20.10 acres!**

**Tract 1 - (18.93) adjusted to 20.10± acres:** 16.99 ± tillable acres. Road frontage on Kropp Road. Currently being farmed. P.I. of 94. This is a buildable tract of land, with Millstadt water available. Tract is made of one parcel number

- **Parcel:** 12-07.0400-013
- **Acreage:** 20.10 acres
- **Taxes:** 2021 - \$278.56

**Fertilizer Fee:** Buyer(s) will pay \$7,373.49 in total for fertilizer that has been applied, divided per tract by tillable acreage. Tract 1 will amount to a total of \$1,450.45.

**Quantity:** 1



**[https://  
www.propertypeddlerauction.com/](https://www.propertypeddlerauction.com/)**